



Dyna-Form[®] Air

I **II** **III**
Clinical Application / PU Grading

Technical Specifications

Product Code	MAT/AIR/200/85/10
Risk Category	High Risk
Weight Limit	No minimum weight limit is required Maximum – 24 stone / 152kg
Warranty	1 Year
Dimensions	Standard size (Length) 200cm x (Width) 85cm x (Height) 10cm
Product Weight	5kg mattress / 2.1kg power unit
Cycle Time	10 minutes
Mode of Operation	Continuous
Voltage	230V / 50HZ
Power Consumption	12W
Colour	Blue

Infection Control / Hypochlorite Solution Compatible
Mattress Cover / Power Unit to be wiped down with Hypochlorite solution and warm water, appropriately diluted.

The **Dyna-Form Air** mattress is a dynamic mattress overlay system suitable for patients considered to be at High Risk of pressure ulcer development. With a fully replaceable cell structure, this system meets clinical needs, infection control challenges and cost management issues. Consisting of 20 cells, even weight management and comfort has been considered within the design process.

With a cycle time of ten minutes, the ultimate pressure ulcer management is achieved, whilst minimising patient nausea. Complete with a slimline, user friendly control unit, functionality becomes simple. An outer cover comprising of high frequency welded, multi stretch, and vapour permeable fabric adheres to the strictest infection control policies which is ideal for use in any ward, homecare or nursing environment.

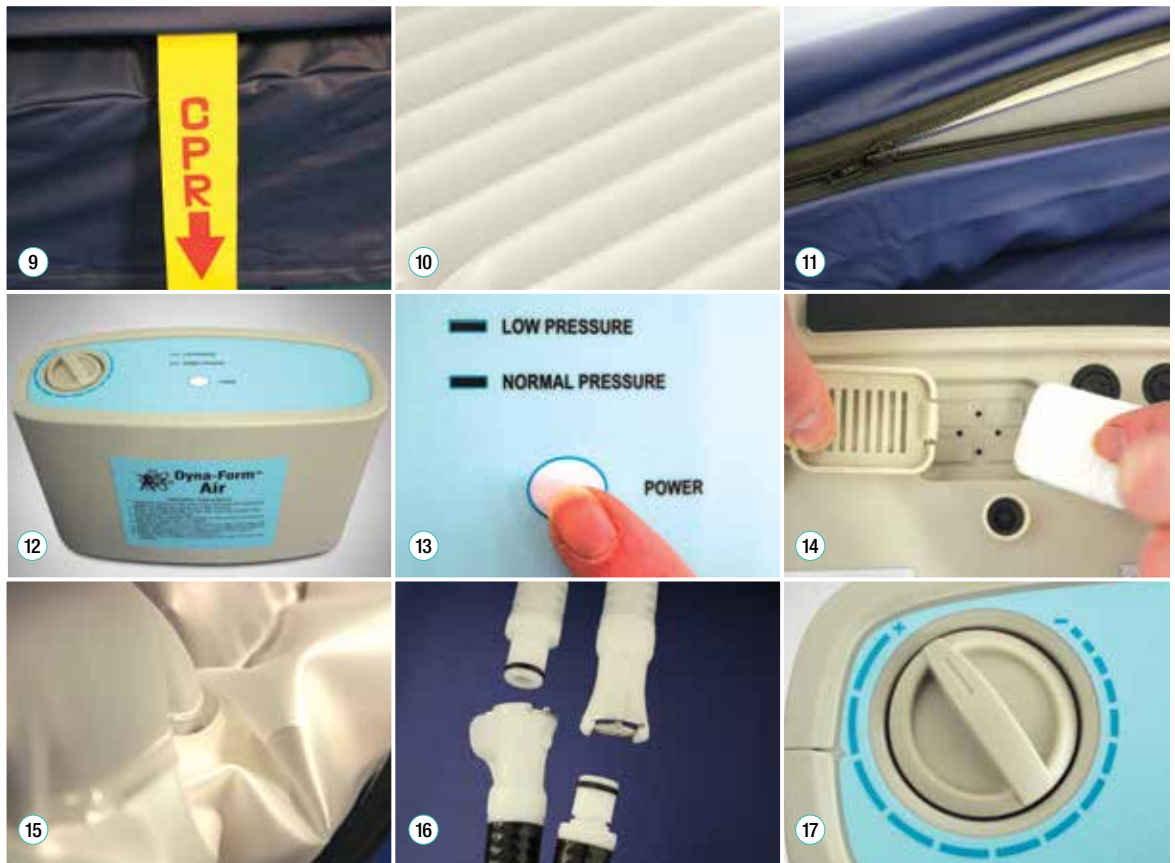

Features

Benefits

- | | |
|---|---|
| ① Fully replaceable inner cell structure | Ideal for basic service and maintenance procedures, controlling cost management |
| ② High frequency welded cover | Enhances infection control procedures and reduces fluid ingress |
| ③ 20 cell design system | Inflates and deflates at regular ten minute intervals, providing ultimate pressure management |
| ④ 2 static head cells | Minimises nausea / maintains stability of the head for neck trauma |
| ⑤ Rear access filter system | For ease of maintenance and cleaning |
| ⑥ Full length securing straps | Ensures safe use for both patient and carer |
| ⑦ Slim line power unit | Basic design for ease of use, avoiding the need for complex training |
| ⑧ LED / Audible warning | Dual indicators alert carers of all functions |
| ⑨ Easy identifiable fluorescent CPR tag – for rapid deflation prior to cardio pulmonary resuscitation procedure | |
| ⑩ Polyurethane cell structure operating at regular ten minute intervals | |
| ⑪ High frequency welded zip flap cover | |
| ⑫ Modern power unit complete with quick release male and female connectors. A removable filter cover allows for basic cleaning and maintenance procedures. Features a dial system for weight application purposes (NB: A variety of pump designs are available to | |
| ⑬ for this overlay system. Please contact your local representative in order to demonstrate these fully) | |